

Timber Harvest Map SF201

Ferdinand-Pike State Forest

Compartment: 3 Tract: 6

County: Dubois Location: S9&10, T3S, R3W

Sale Date: May 21, 2020 @ 10:00 AM

Sale Number: 6312003

Marked by: Winner / McDivitt

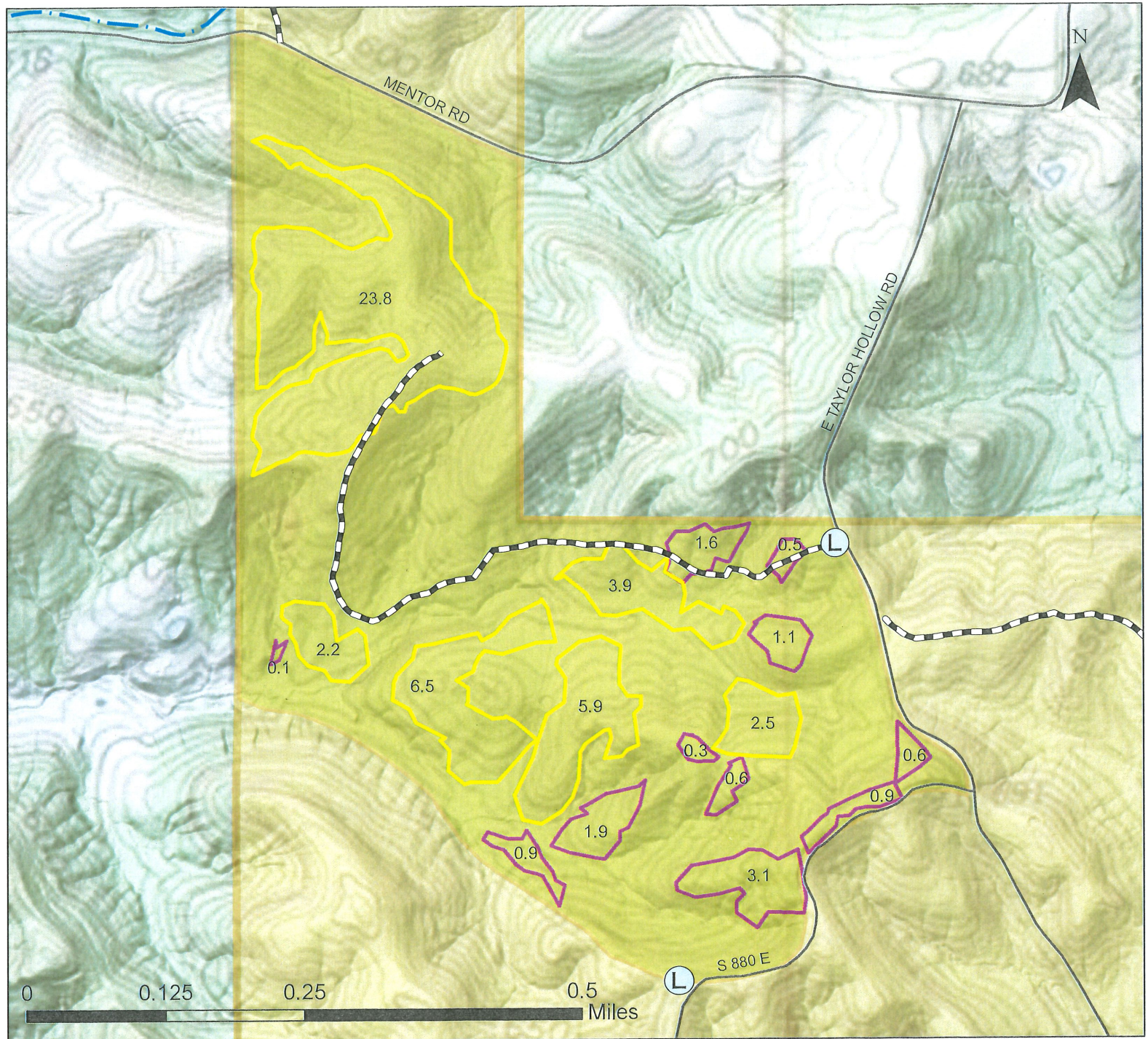

Legend

- Harvest Area
- acres Boundary Openings
- Log Yards
- Firelane
- State Forest
- acres Regen. Openings

Harvest Numbers:

Harvest Area: 177 acres

Number of Trees: 3,308

Number of Poles: 5,614

Number of Culls: 6

Estimated Harvest Volume: 628,258 bdft

Estimated Pole Volume: 603.4 cords



Sale Notice

Indiana Department of Natural Resources,
Division of Forestry
SF203

2018

Notice is hereby given at the following time and date: May 21, 2020 @ 10:00 AM

The State Forester, acting for the Indiana Department of Natural Resources and the Director of Public Works and Supply, will offer for sale the following described property (volumes are estimated):

Individually Marked Tally:

Paint Color: BLUE

SPECIES	# Trees Sawtimber	Volume - Doyle Board Feet	# Trees Poles	Pole Volume Cords	Culls
Yellow Poplar	189	73,831	67	9.1	1
Chestnut Oak	303	56,307	145	14.6	1
White Oak	153	33,286	46	6.0	0
Virginia Pine	153	24,714	162	27.2	0
Eastern White Pine	49	22,817	28	1.6	0
Black Oak	92	22,074	10	1.5	0
Shortleaf Pine	71	15,700	49	8.4	0
Northern Red Oak	23	7,656	1	0.0	0
Sugar Maple	57	5,505	190	18.4	2
Red Maple	40	5,502	115	7.5	2
Scarlet Oak	25	5,123	4	0.4	0
Pignut Hickory	35	4,758	21	2.6	0
White Ash	34	4,033	106	18	0
Black Cherry	24	2,454	13	1.3	0
American Sycamore	10	2,042	4	0.3	0
Bitternut Hickory	5	1,735	10	1.6	0
American Beech	12	1,709	21	1.5	0
Blackgum	13	1,486	37	2.7	0
Post Oak	13	1,211	16	2	0
Sweetgum	3	532	0	0	0
Largetooth Aspen	3	260	7	1.1	0
Red Pine	1	71	1	0.2	0
American Elm	1	71	8	0.5	0

Sassafras	1	57	5	0.3	0
Red Elm	1	41	0	0	0
Green Ash	0	0	2	0.2	0
Persimmon	0	0	2	0.1	0
Shagbark Hickory	0	0	1	0.1	0
Totals	1,311	292,975	1,071	127.2	6

Boundary Opening Tally (#Trees Estimated):

Boundary Paint Color: Yellow

SPECIES	# Trees Sawtimber	Volume - Doyle Board Feet	# Trees Poles	Pole Volume Cords	Culls
Shortleaf Pine	1,066	182,752	1,318	181.1	0
Yellow Poplar	192	54,748	303	13.2	0
Virginia Pine	364	43,948	1,344	189.6	0
Eastern White Pine	181	35,623	158	21.9	0
Red Maple	40	4,700	465	16.5	0
Sugar Maple	69	4,455	417	19.5	0
Black Cherry	34	2,197	159	13.9	0
Loblolly Pine	5	1,770	0	0	0
Pignut Hickory	12	1,335	47	2.3	0
Sweetgum	3	1,240	0	0	0
Scarlet Oak	5	1,029	0	0	0
Sassafras	5	595	44	1.5	0
White Ash	10	553	88	6.5	0
Blackgum	11	338	94	5	0
Persimmon	0	0	43	2.6	0
American Elm	0	0	20	1.7	0
American Beech	0	0	43	0.9	0
Totals	1,997	335,283	4,543	476.2	0

Sale Total (#Trees Estimated):

# Trees Sawtimber	Volume - Doyle Board Feet	# Trees Poles	Pole Volume Cords	Culls
3,308	628,258	5,614	603.4	6

This is Indiana State Forest Timber Sale Number 6312003.

The public sale is to be held in the offices of:

Ferdinand-Pike State Forest, 6583 E SR 264, Ferdinand, IN 47532 (812) 827-2857

The sale has the following conditions:

Division of Forestry BMP requirements apply to sale. There will be a minimum of 1 person (crew and/or supervisor) on an active logging site at all times that has met the following training standard: A minimally trained individual will have Indiana Cutter Level 1 and Intro to BMP. These trainings are required to have been taken within the last 3 years to be valid. Buyer must ensure traffic is directed and road properly flagged during harvest along county road.

The timber specified in this document is Certified Wood. Indiana State Forests are certified by both the Sustainable Forestry Initiative® (SFI®) Program and the Forest Stewardship Council® (FSC®). Purchasers of State Forest timber may market state forest timber products as certified if they have the appropriate Chain of Custody certificate.

The FSC Certificate Number for Indiana State Forests is SCS-FM/COC-00099N. The FSC claim is "FSC 100%".

The SFI Certificate Number for Indiana State Forests is NSF-SFI-FM-6L841.

Sealed bid for such property will be received at the office of the Property Manager until the hour and date above set out, at which time and place all acceptable bids will be publicly opened and read aloud, and any bids received after the designated time will be returned unopened.

Bidders in good standing are required to submit a check (completely filled out) for an amount equal to or larger than five percent (5%) of their bid amount payable to the Indiana Department of Natural Resources with their bid as a performance deposit. Bidders not in good standing are required to submit a performance deposit for an amount equal to or larger than 10% or 20% of their bid, depending on the level of their standing as provided to them by the Indiana Department of Natural Resources. The performance deposit amount is not part of the total sale (bid) payment, but is a separate payment. Failure to comply with conditions and requirements of the executed contract may result in a forfeiture of a portion or all of this performance deposit.

The property will be sold under written contract to the responsible bidder making the highest sealed bid, provided the bid is acceptable to the state. The winning bidder must make a payment equal to or larger than ten percent (10%) of the bid amount within fourteen calendar days of the bid opening. The winning bidder must return the executed timber sale agreements to the Indiana Department of Natural Resources within one month of the bid opening date. The remaining bid amount balance, if any, shall be paid within one year of the bid opening or prior to the start of harvest operations, whichever occurs first. The bidder may pay the entire bid amount within fourteen calendar days of the bid opening. Failure to pay at least a ten percent

(10%) down payment or the full bid amount within fourteen calendar days from the date of bid opening will result in a forfeiture of all of the performance deposit. Failure to pay the total bid amount within the prescribed time will result in a forfeiture of all of the performance deposit and any down payment. The terms of the sale will be cash, the buyer to accept delivery of the property and to remove the property therefrom by May 21, 2022, which will be the expiration date of said contract. The Department reserves the right to accept and/or reject any and/or all bids. The Department (at its discretion) reserves the right to rebid the sale.

Bid Information		
State Forest: Ferdinand-Pike State Forest	Sale Number: 6312003	Sale Date and Time: May 21, 2020 @ 10:00 AM
Bidder Name (print and sign):		License Agent Number:
Address:		Bid:

Notes
Only current licensed buyers or their registered agents may submit bids. Buyer should satisfy himself as to volume in sale.

Timber Sale Information

SALE NUMBER: 6312003

Bidder	Bid Price	Accepted Bid
Werner Sawmill	\$162,162.00	Bid Accepted
Werner Specialty Hardwoods	\$122,250.00	

Contract Length

May/21/2020 – May/21/2022

Extensions may be necessary to maximize sustainability standards due to weather, wildlife or recreational activities.