

Boot Lake Nature Preserve

County: Elkhart Size: 200.87 acres
Ownership: City of Elkhart



Location and Access

Parking and trail. From the north side of Elkhart, take CR 4 west to CR 5 (Edwardsburg Rd), just past a cemetery, and turn right (northwest). After a short distance the road splits. Take the right half (CR 3) and go about 0.4 mile to Williams lane on the right. Park in the lot at the end of the lane.

An alternative is to take SR 19 north from Elkhart to CR 4 (just past I-80/90 toll rd). Continue as above.

From South Bend, pick up US 20. Go east on US 20 toward Elkhart. Take the SR 19 North exit and go through Elkhart to CR 4 (just past I-80/90). Turn left (west) and go about 2.4 miles to CR 5 (Edwardsburg Rd). Continue as above.

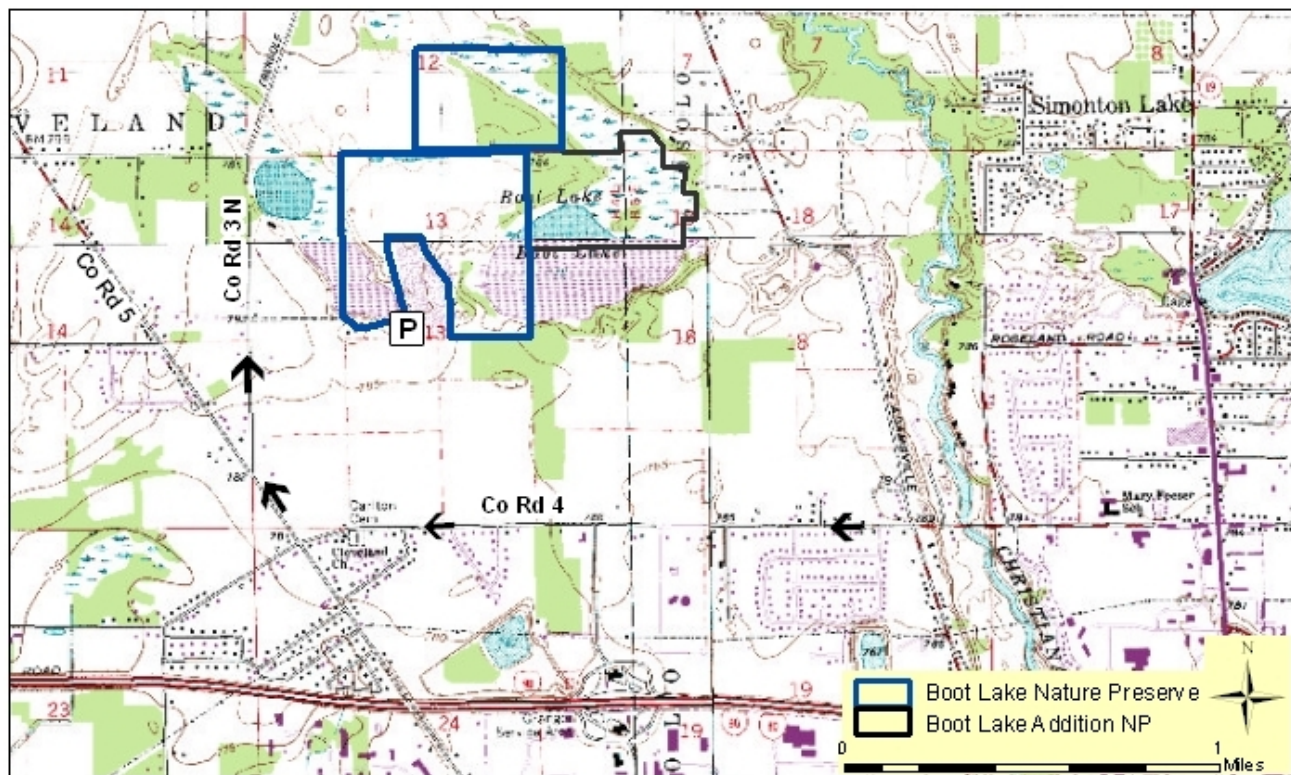

Further Information:

City of Elkhart, Board of Public Works & Utilities, 1201 S. Nappanee St., Elkhart, IN 46516.

(574) 293-2572. www.elkhartindiana.org.

Division of Nature Preserves Northeast Regional Ecologist, Rich Dunbar: rdunbar@dnr.in.gov

Boot Lake Nature Preserve

Description: This wetland area, a part of a larger 100-acre wetland complex, is made up of kettle lakes (formed by glaciation) that are in the process of naturally filling in, and have succeeded into rare types of wetlands known as hydric peaty muck flats and hydric peaty sand flats. These support disjunct Atlantic Coastal Plain plants, a number of which are rare. Also in the area are buttonbush swamps, upland woodlands and fields, and a prairie restoration site.

Some of the plants found here are a variety of rushes and sedges, blue joint grass, meadow beauty, sugar maple, American beech, and red oak. Sandhill Cranes have nested here in recent years.

This preserve was purchased with funding from the Indiana Heritage Trust Project.



Sandhill Crane



Boot Lake



Water Lilies