



# Building South Bend

Digitally Archiving & Presenting  
Community Records to Promote Urban  
History & Development

Great Lakes Main Street Conference  
August 19, 2019

Elicia Feasel,  
City of South Bend

Jennifer Parker, Architecture Librarian  
University of Notre Dame

# Overview

- History of Collaboration
- Background of Building South Bend
- Current project
- Community Outreach
- Future

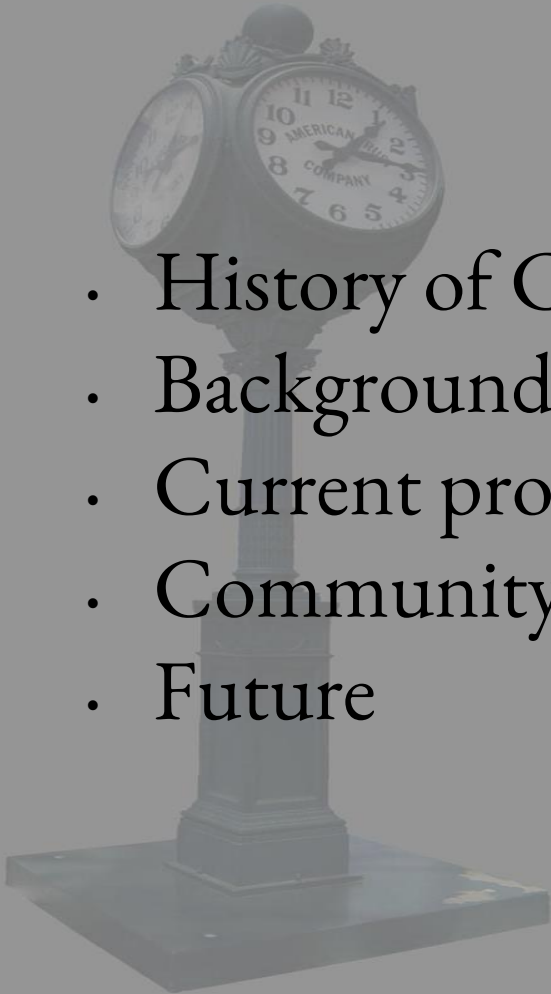

# A Call to Action

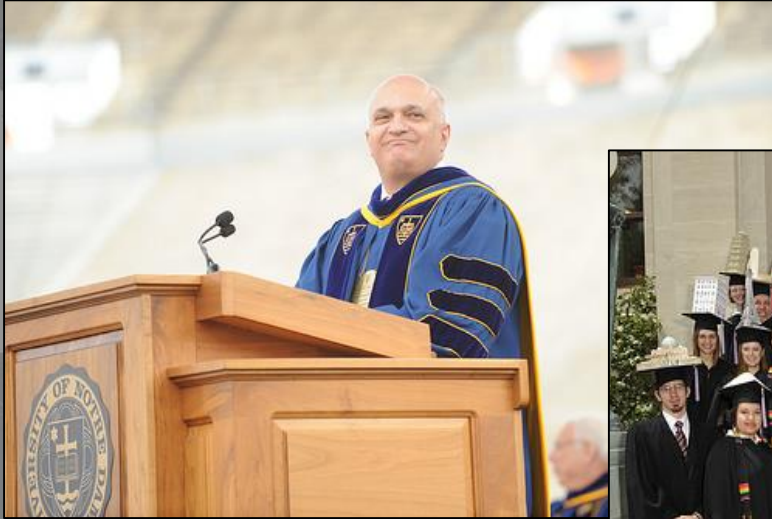

# Architecture Library

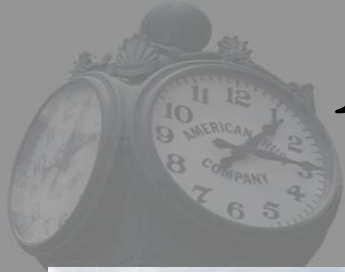

# HUE/ND

The Historic Urban Environments Lab (HUE/ND) at Notre Dame is an interdisciplinary team of architects, computer scientists, librarians, programmers, anthropologists and GIS specialists whose goal is to create new tools linking traditional library resources with new technologies. Building off of previous digital projects created by the Architecture Library, the Seaside Research Portal, SPQR-ND, and Building South Bend the team is currently working on several web sites and applications to better study the built environment virtually by linking historic content and traditional library resources with geo-location and digital technologies.



# Historic Preservation Commission

of South Bend and St. Joseph County





# The Birth of Building South Bend

THE SEASIDE RESEARCH PORTAL  
Archiving the First New Urban Community

About Seaside Planning Seaside Building Seaside Interactive Map

See 360° of Seaside

Featured Building

THE SEASIDE RESEARCH PORTAL  
A collaboration between the Hesburgh Libraries and School of Architecture  
About the Portal Terms of Use Search the Portal University of Notre Dame

Local Historic Districts of South Bend, Indiana  
Heritage Tour

Historic Preservation Commission of South Bend & St. Joseph County

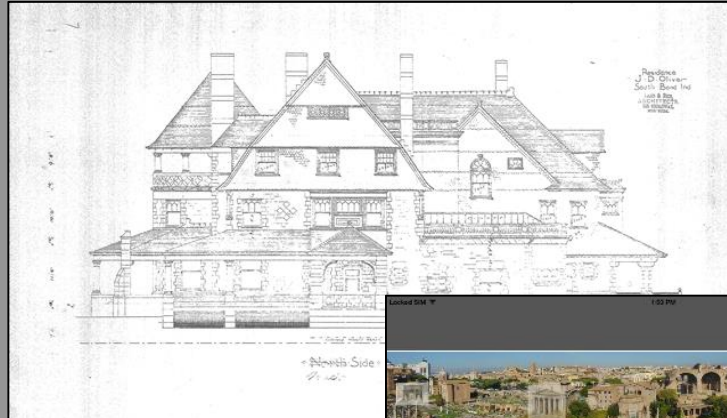

Home Map Browse Layers About

SPQR-ND

INTERPRETING THE ROMAN FORUM THROUGH EARLY ARCHITECTURAL PUBLICATIONS

A collaborative project between the Hesburgh Libraries and the University of Notre Dame School of Architecture

©2014-The University of Notre Dame





# Initial Plan

## The Architecture and Urbanism of South Bend A Virtual Guide to the Historic Architecture of South Bend and Plans for its Revitalization

### Project Overview

The Hesburgh Libraries of Notre Dame's Architecture Library (<http://architecture.library.nd.edu>) has partnered with South Bend's Center for History (<http://centerforhistory.org/>) and the Historic Preservation Commission of South Bend and St. Joseph County (<http://www.stjosephcountyindiana.com/departments/SJCHP/>) to create an online resource to study the past, present, and future architecture in the city of South Bend. The resource is intended to provide access to documentation and blueprints of historic architecture and historic districts that have been demolished as well as those that currently still exist. Proposals for the revitalization of undeveloped urban districts and locations within the city that have been prepared by students of Notre Dame's School of Architecture will also be included.

### Project Partners and Lead Contacts

Architecture Library, Jennifer Parker, [jparker9@nd.edu](mailto:jparker9@nd.edu)  
Center for History, Brandon Anderson, [dedp@centerforhistory.org](mailto:dedp@centerforhistory.org) and Kristen Madden, [archives@centerforhistory.org](mailto:archives@centerforhistory.org)  
Historic Preservation Commission, Elicia Feasel, [EFeasel@co.stjoseph.in.us](mailto:EFeasel@co.stjoseph.in.us)  
Preservation and Conservation, Liz Dube, [ldube@nd.edu](mailto:ldube@nd.edu)

# Project Resources - HPC



# Project Resources - Architecture

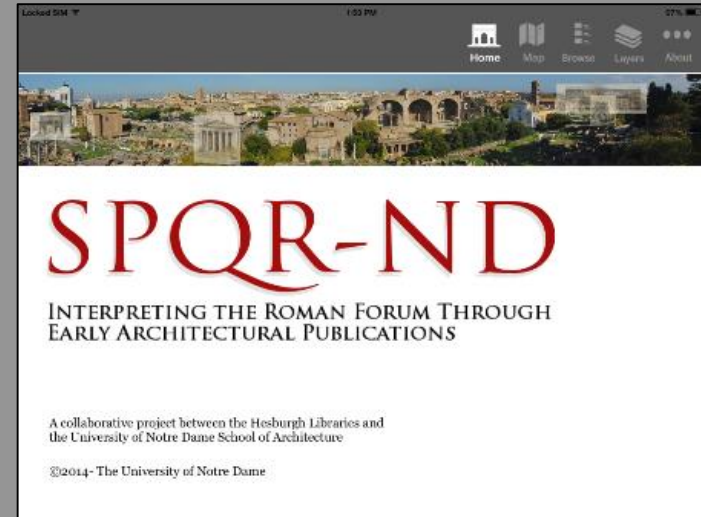

Website Model:

[Http://www.seaside.library.nd.edu](http://www.seaside.library.nd.edu)

u

Mobile Application Model

# Building South Bend

UNIVERSITY of NOTRE DAME

## Building South Bend

PAST, PRESENT, & FUTURE

Search

CONTACT

Home

History

Historic Districts

Interactive Map

Virtual South Bend

About

## Exploring South Bend's history through Architecture

Utilizing interactive technology, *Building South Bend: Past, Present, & Future* documents, describes, and presents the **historical architecture and neighborhoods of South Bend, Indiana**. This unique tool offers historical images, blueprints, and documents along with interactive maps and 3D models.

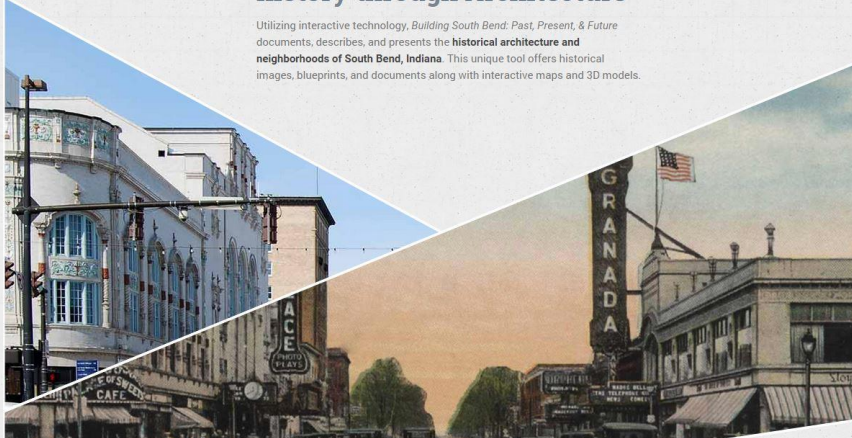

# Initial Launch



# Building South Bend

PAST, PRESENT, & FUTURE



# Mobile Application

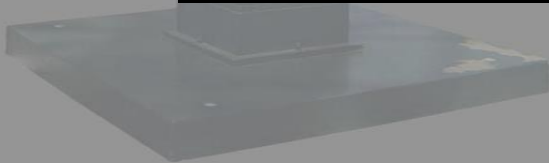
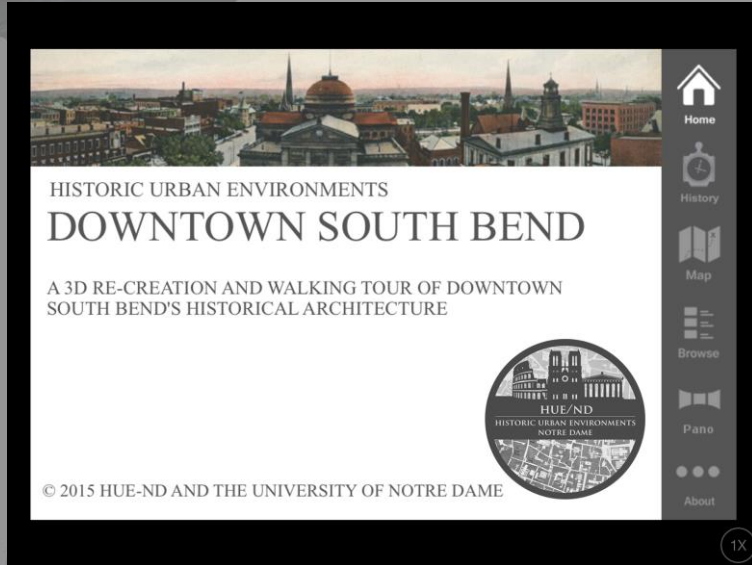

# 3D Printed Model





# Building the 3D Model



# Building the 3D Model

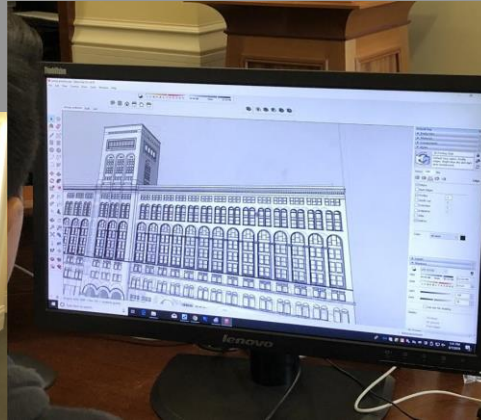
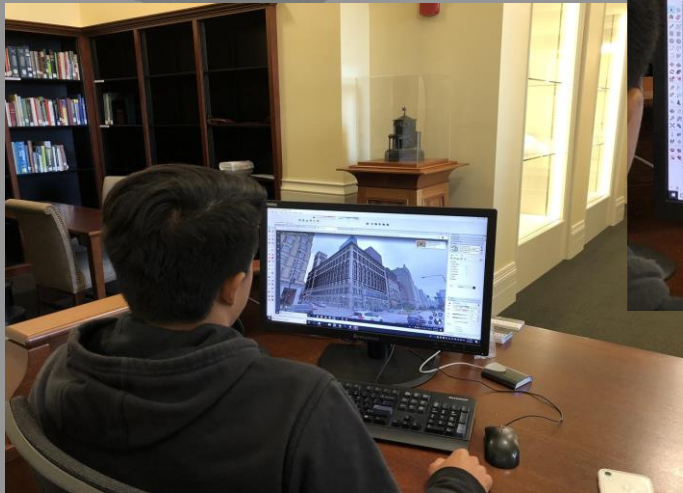

# Building the 3D Model



# Virtual Reality



# Virtual Reality



# Current Uses



# Publicity

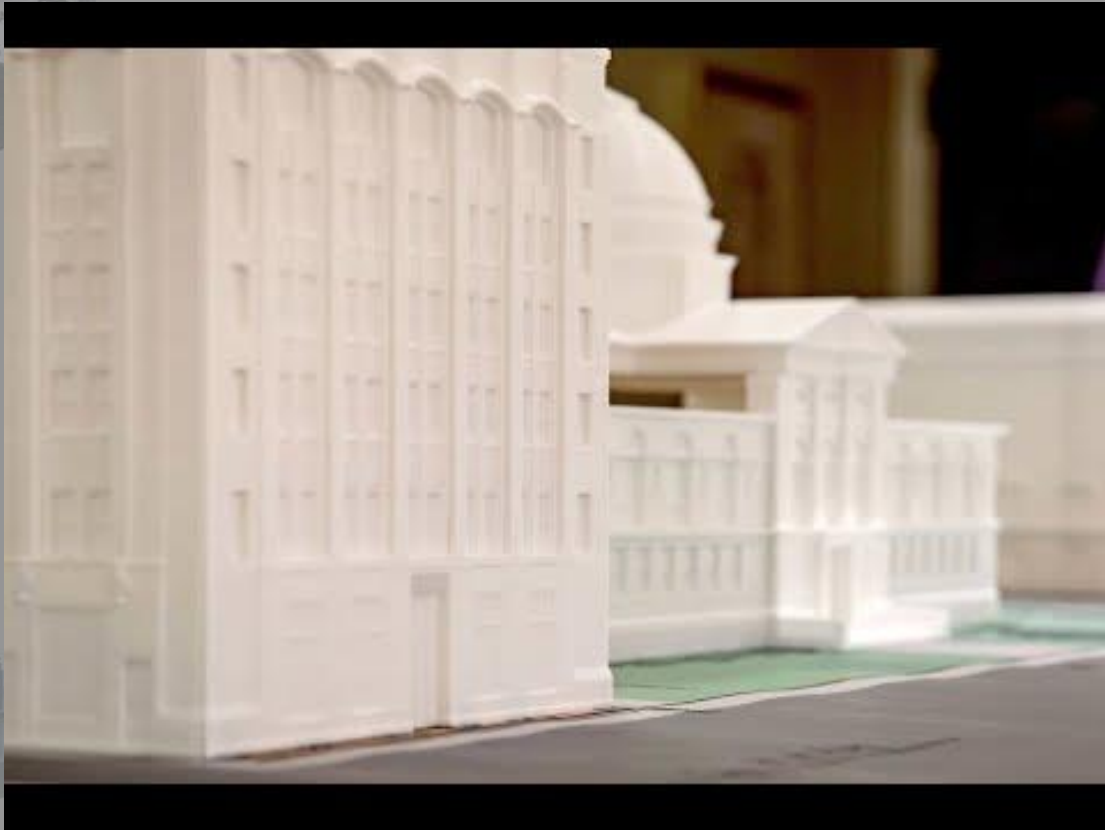

# Future Plans





# VR Demo



# Future Plans





# Explore South Bend!

Please visit the Apple App Store and download the free mobile application.

Join us on a guided tour of SB utilizing the mobile app.